



AGITO
M E D I C A L

Site Planning Guide

PHILIPS Ingenua Ambition 1.5T

MR51/52 - MRI Relocatable

01 Introduction

02 Relocatable unit specifications

- Dimension and weight
- Magnetic shielding
- Access to the mobile unit

03 Environmental requirements

- Physical requirements
- Electricity
- Water
- Connectivity

04 Before delivery

- Preparations of access route

05 Relocatable unit layouts

- 3D Tour of Relocatable MRI

01 Introduction

This Site Planning Guide provides information to potential customers on the preparations they would need to make so that this Relocatable MRI Rental Solution can be successfully delivered, sited, and put into clinical operation.

The customer site must be prepared in accordance with the details given in this guide so that that relocatable unit & the installed medical equipment will function properly. This guide exclusively describes the Unit and its siting, environmental & electrical requirements, and is meant to give outline details. Further detailed specifications & site requirements are available upon request.

Please refer to the System Spec Sheet for specifications of the installed PHILIPS AMBITION X Scanner and associated equipment, and for further detail on the unit features.

02 Relocatable Unit Specifications

2.1 Dimension and weight

Length	15 m
Width	3.95 m
Height	3.2 m
Weight of unit	32,000 kg
Min. area for placement (subject to site survey)	19 x 8 m

2.2 Magnetic shielding

The Relocatable MRI unit is equipped with magnetic shielding. The shielding will keep the magnetic field outside the trailer walls below 0.5mT. On the roof the magnetic field will be much stronger. Inside the relocatable, in the scan room, the magnetic field is much higher than 0.5mT. These areas are marked with the required MRI safety signs, provided by the manufacturer

2.3 Access to the relocatable unit

The relocatable MRI has 3 points of access available. The exterior areas of the unit are covered by CCTV system control of entry.

- 2 Patient Access doors (end & side)
- Technical Room / Equipment Access

03 Environmental Requirements

3.1 Physical requirements

The unit will usually be delivered on a low-loader, and sited using the Hydraulic System. However, the unit can also be lifted into more demanding locations using a crane. There is a range of options for delivery, so access routes must be assessed by an AGITO Project Manager to ensure the best options are being taken.

- Area to be provided: 19.00 m x 8.00 m (L x W) subject to a site survey
- A clearance of at least 2m is required all around the unit so that the unit can be maintained and allow enough space for the Air-conditioning to function correctly. This clearance allowance should always be respected and is included in the area requirement. Exceptions to the above requirements are possible but can only be approved by an AGITO representative on a site survey. Additional space for patient trolley access and ramp/staircase may be required depending on the site layout.
- Any high voltage electrical installations close to the requested location may interfere with magnetic field. Further info can be obtained upon request.
- Large moving/active metal objects – e.g. cars, busses, escalators, forklifts, trucks, helicopters, ambulances, elevators etc. should be kept at distance of min. 10 meters from magnet iso-center in order to ensure no disturbance is caused.
- Siting of the Relocatable must be made on a solid surface that is level, with a maximum 50mm deviation in height per 10m, with a loading capacity of 32,000 Kg (32 tons). Site access must also be able to carry the weight of the low loader, head unit and depending on deployment method a crane. Additional reinforcements are required on unstable ground. Suitable reinforcement could be concrete, road surfacing or pavement (bound material).
 1. When the Relocatable is deployed, it should be supported by a minimum of 18 support pads (see diagram below)
 2. Each of the 18 support pads should be capable of a load capacity of at least 3500kg.

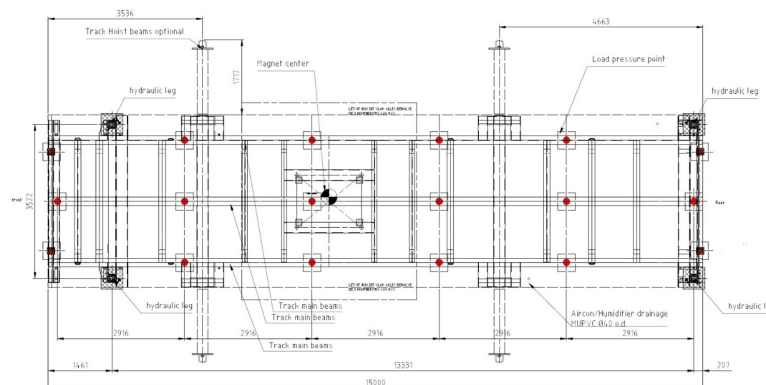

 - Load per Pressure point = 3500 kg

3.2 Electricity

400V
3 phase
Phase Rotation – L1, L2, L3 (TN-S)
50HZ
200A
Female Marachell DS2 Connector with Dedicated
Insulated Neutral & Earth.

NOTE: A stable electric power supply meeting above specifications must be provided by the customer for the whole rental.



Norm connection plug

3.3 Water

The unit is equipped with a sink, which can provide hot & cold water if connected to a clean, cold-water supply. A wastewater outlet would need to be connected to the unit and a means of drainage provided for this facility to be utilized.

3.4 Connectivity

The Units Technical Room houses; -

- RJ45 ethernet (CAT 6) connection points. Alongside the OpenRad CUBE, this allows secure, easy integration to the customers HIS/RIS & PACS systems and allows secure remote support from OEM Service providers.
- Qty 2 Phone connection points that link direct to the Control Room.
- Fire Alarm Connection points – these can be used to connect the on-board alarms to the hospital Fire Alarm system.

04 Before Delivery

4.1 Preparations of access route

An AGITO project manager will be made available for a site survey & consultation prior to Rental and Unit Delivery. They will advise customer on best practice for siting & placement of the unit and access requirements etc. The customer is then responsible for all necessary preparations as advised by the AGITO Project Manager.

05 Relocatable Unit Layouts

5.1 Relocatable unit layouts

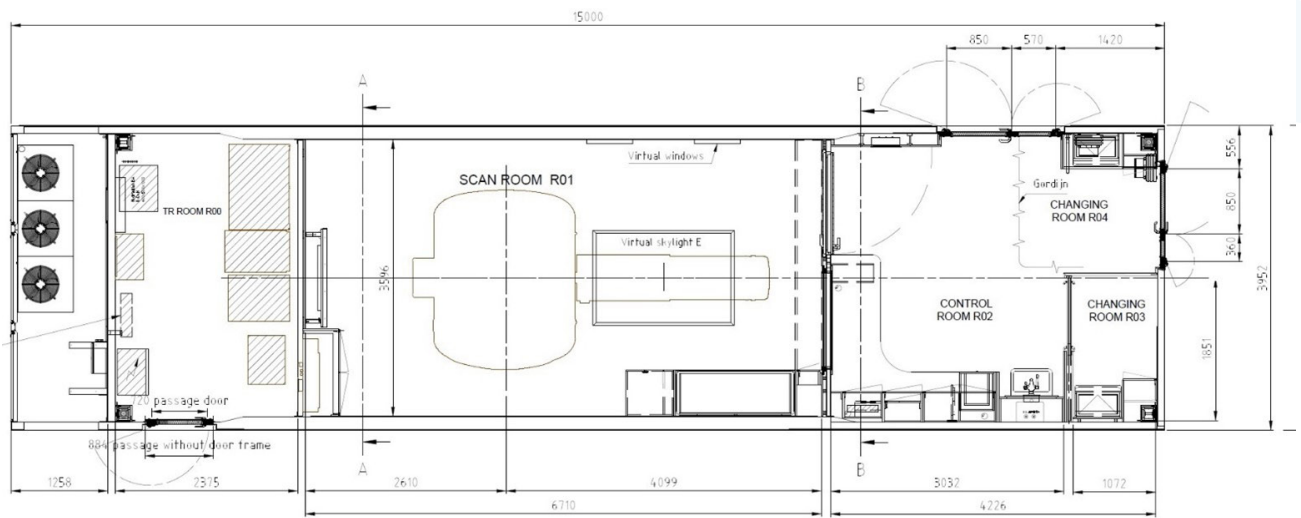

5.2 3D tour of unit

Do you want to see how it looks inside the Relocatable MRI unit?

Take a 3D tour by scanning the QR code below..

