



**AGITO**  
MEDICAL

Site Planning Guide

**SIEMENS go.TOP**

CT24 - Relocatable CT Trailer

## 01 Introduction

## 02 Relocatable unit specifications

Dimension and weight

Radiation Protection

Access to the unit

## 03 Environmental requirements

Physical requirements

Electricity

Water

Connectivity

## 04 Before delivery

Preparations of access route

Vehicle access requirements

## 05 Relocatable unit layouts

Layouts

QR code to 3D tour of unit

# 01 Introduction

This Site Planning Guide provides information to potential customers on the preparations they would need to make so that this Relocatable CT Rental Solution can be successfully delivered, sited, and put into clinical operation.

The customer site must be prepared in accordance with the details given in this guide so that that relocatable unit & the installed medical equipment will function properly. This guide exclusively describes the Unit and its siting, environmental & electrical requirements, and is meant to give outline details. Further detailed specifications & site requirements are available upon request.

Please refer to the System Spec Sheet for specifications of the installed SIEMENS CT Scanner and associated equipment, and for further detail on the unit features.

# 02 Relocatable Unit Specifications

## 2.1 Dimension and weight

|                         |                            |
|-------------------------|----------------------------|
| Type                    | Relocatable                |
| Length of Unit          | 14m                        |
| Width                   | 4.0m                       |
| Height                  | 3.4m                       |
| Weight of unit          | 36,000Kg (36T)             |
| Min. area for placement | 18m x 8m - Subject to site |

## 2.2 Radiation Protection

Lead Shielding has been installed into the mobile to meet the required Radiation Protection Standards. Despite this, a very low level of radiation can exist outside of the unit. Therefore the unit should be placed in an area that keeps the exposure minimal to outdoor personnel, and the environment.

|                             |             |
|-----------------------------|-------------|
| Exterior Walls              | 2.5mm       |
| Internal Separation Walls & | 3.00mm      |
| Floor / Roof                | 2.5mm / 2mm |
| Doors to scan room          | 3mm         |



## 2.3 Access to the unit

The relocatable CT has 3 points of access available; **2 Patient Access doors (end & side)** and a Technical Room/Equipment Access. The Unit has an Intruder Alarm installed and electronic keypad to control entry to the unit. The exterior areas of the unit are covered by CCTV system for control of entry.

# 03 Environmental Requirements

## 3.1 Physical requirements

- Area to be provided: 18m x 8m
- A clearance of at least 2m is required all around the unit so that the unit can be maintained, allow enough space for the Air-conditioning to function, and allow safe use of the patient access doors etc. This clearance allowance should always be respected and is included in the area requirement. Exceptions to the above requirements are possible but can only be approved by an AGITO representative on site survey.
- Siting of the mobile must be made on a solid surface that is level, with a maximum 1% gradient (0.6 deg), with a loading capacity of 36,500 Kg (36.5 tons). Site access must also be able to carry the weight of the low-loader & head unit.
- When the unit is deployed, there are 10 points on the unit chassis which must be supported by a concrete pad of at least 1m<sup>3</sup> with a load capacity of at least 10.000kg (10 tons). Nylon Support Blocks are supplied with the unit to protect the pad surface.

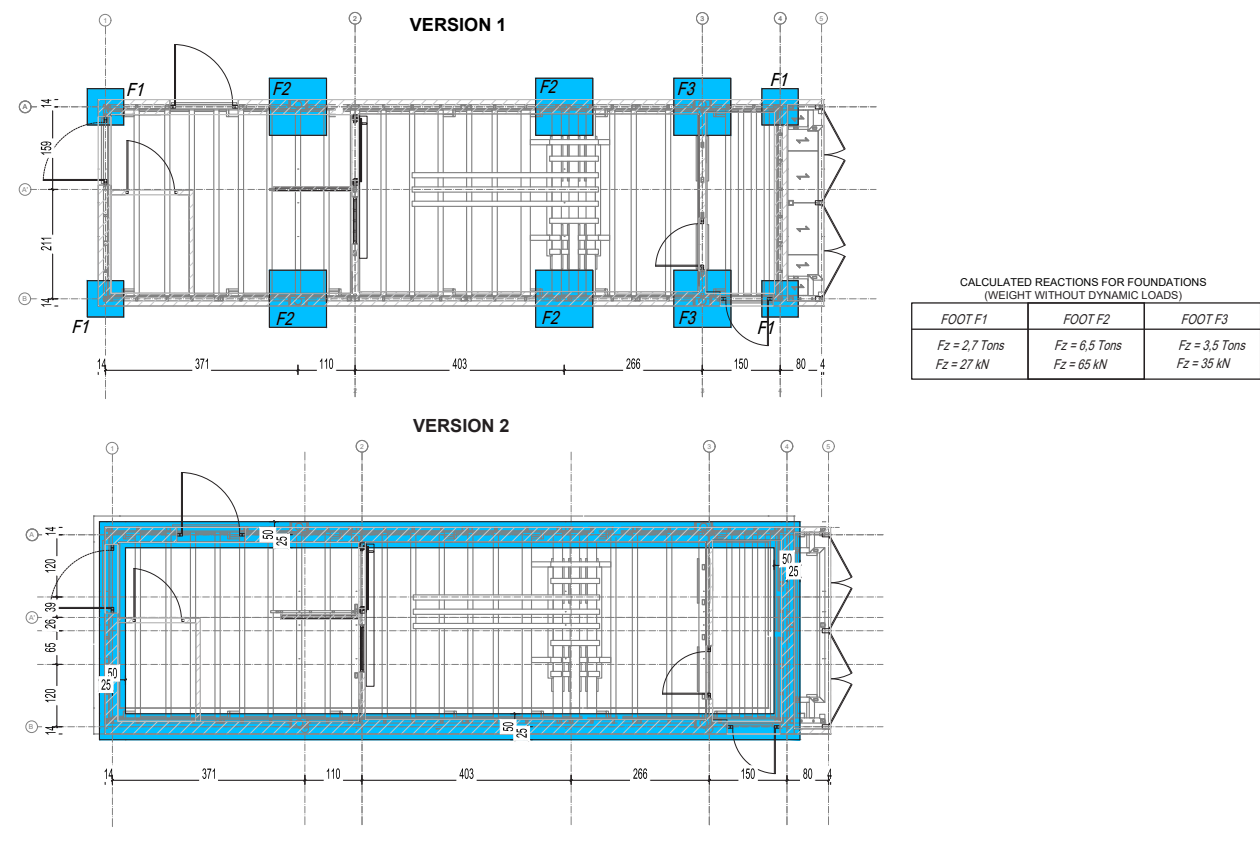

## 3.2 Electricity

400V  
3 phase  
Phase Rotation – L1, L2, L3 (TN-S)  
50HZ  
200A  
Female Marechal DS2 Connector with Dedicated Insulated Neutral & Earth.  
NOTE: A stable electric power supply meeting above specifications must be provided by the customer for the whole rental.



Please note: The Marechal connector must not be removed under any circumstances

## 3.3 Water

The unit is equipped with a sink, which can provide hot & cold water if connected to a clean, cold-water supply. A wastewater outlet would need to be connected to the unit for this facility to be utilized.

## 3.4 Connectivity

The Units Technical Room houses:

- RJ45 ethernet (CAT 6) connection points. Alongside the OpenRad CUBE, this allows secure, easy integration to the customers HIS/RIS & PACS systems and allows secure remote support from OEM Service providers.
- Qty 2 Phone connection points that link direct to the Control Room.
- Fire Alarm Connection points – these can be used to connect the on-board alarms to the hospital Fire Alarm system.

# 04 Before Delivery

## 4.1 Preparations of access route

- An AGITO project manager will be made available for a site survey & consultation prior to rental and unit delivery. They will advise customer on the best possible siting & placement of the unit and access requirements etc. **The customer is then responsible for all necessary preparations as advised by the AGITO Project Manager.**
- The route to the installation location has to be trafficable for the tractor and vehicle access requirements seen below.
- If additional site visit is requested by the customer, AGITO Medical reserves the right to invoice this expense separately.
- All obstacles, parked cars, low branches or other potential non-conformities to a failure-free access, are to be removed prior to delivery.

Please note: The client is responsible for all necessary preparations of the installation location, the access route, as well as the provision of the required connections.

## 4.2 Vehicle access requirements

The unit will usually be delivered on a low-loader, and sited using the Hydraulic System. However, the unit can also be lifted into more demanding locations using a crane. There is a range of options for delivery, so access routes must be assessed by an AGITO Project Manager to ensure the best options are being taken.

# 05 Relocatable Unit Layouts

## 5.1 Relocatable unit layouts

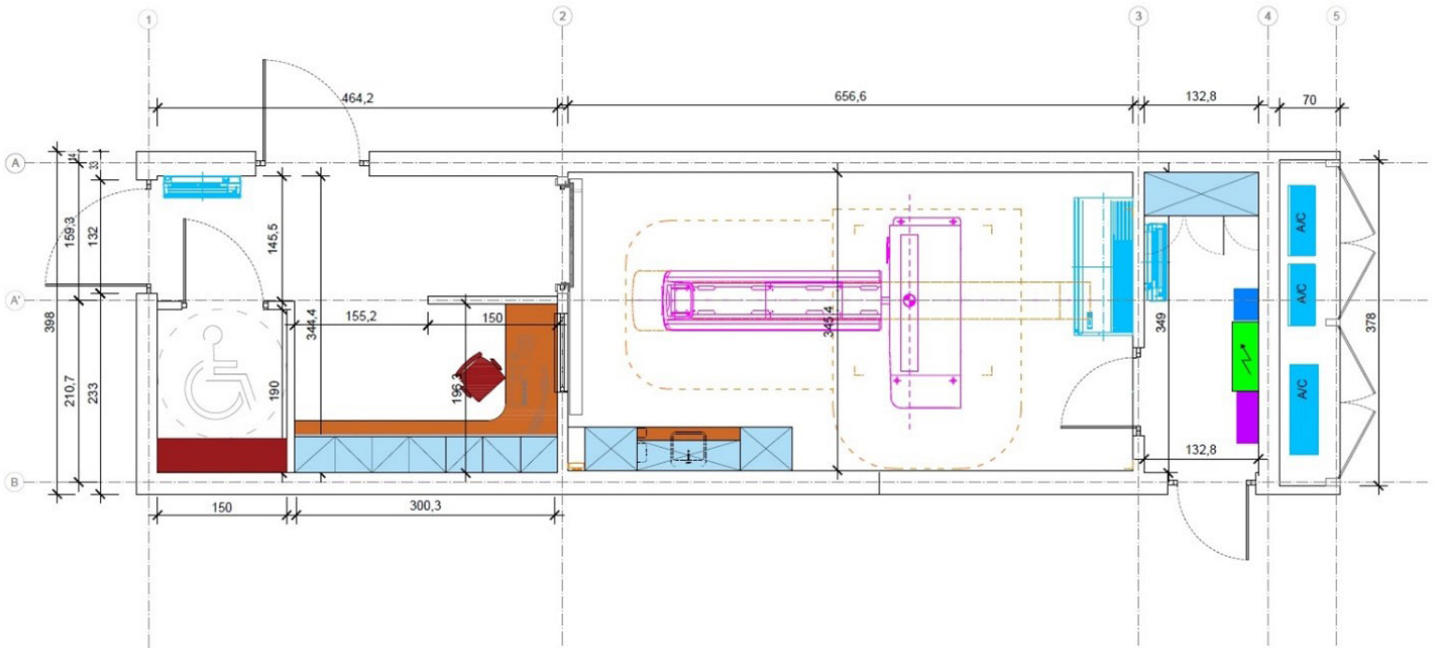

## 5.2 3D tour of unit

Do you want to see how it looks inside the Relocatable CT unit?

Take a 3D tour by scanning the QR code below..

